

Removal and Installation of Brake Unit 42.1

Revision: Tightening torques added.

Data

Brake unit		Teves T 51/1801	
Diameter	inches	9	
	mm	228.6	
Boosting factor		approx. 4.5	
Tightening Torques		Nm	(kpm)
Hex. nuts for attaching brake unit to front end		15	(1.5)
Pipe nut of vacuum line to brake unit		30	(3)

Removal

- 1 On vehicles with manual transmission, remove connecting hose (7) to master cylinder.
- 2 Remove tandem master cylinder (42.1—310).
- 3 Loosen vacuum line (8) on brake unit (6) (Fig. 1).

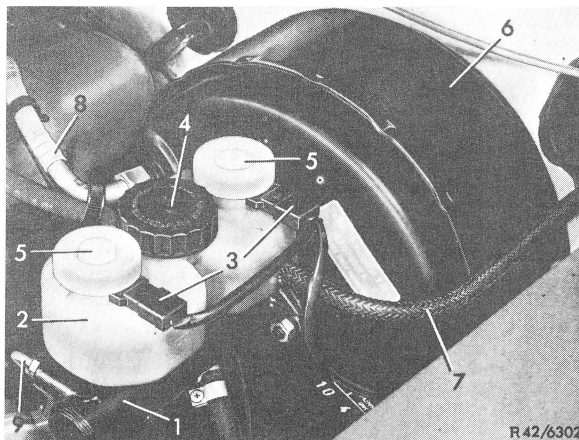

Fig. 1

- | | |
|--------------------------|---|
| 1 Tandem master cylinder | 6 Brake unit |
| 2 Compensating tank | 7 Connecting hose |
| 3 Plug connection | 8 Vacuum line |
| 4 Closing cover | 9 Brake line for right-hand front wheel brake |
| 5 End cover | |

- 4 Remove rubber cover (18) on front end and unscrew hex. nut (9) (Fig. 2 and 3).

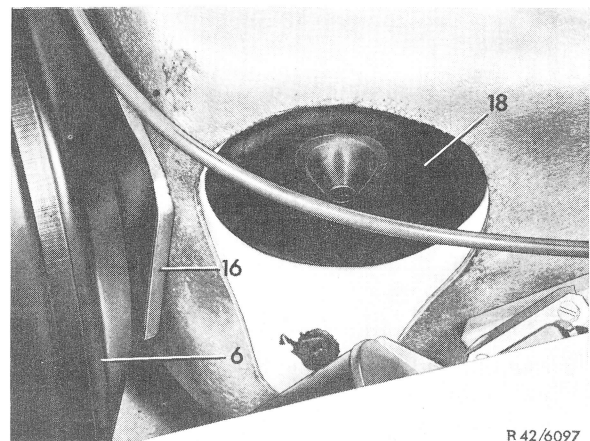

Fig. 2

- | | |
|-----------------------|-----------------|
| 6 Brake unit | 18 Rubber cover |
| 16 Intermediate plate | |

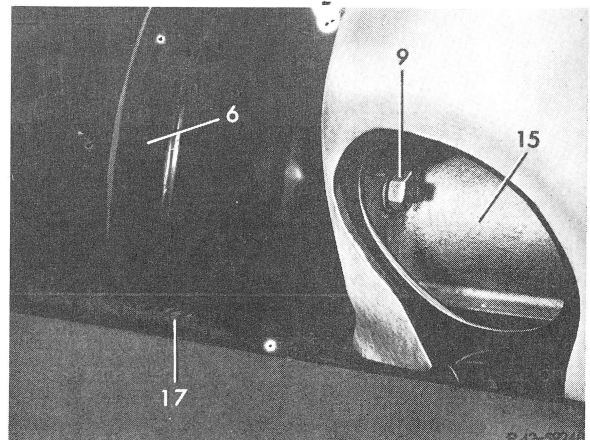

Fig. 3

- | | |
|--------------|--------------------|
| 6 Brake unit | 15 Carrier |
| 7 Hex. nut | 17 Connecting hose |

42.1 Removal and Installation of Brake Unit

5 Unscrew cover underneath instrument panel in legroom (3) and pull downwards. Push out legroom light (4), remove plug and pull cable from cover (Fig. 4 and 5).

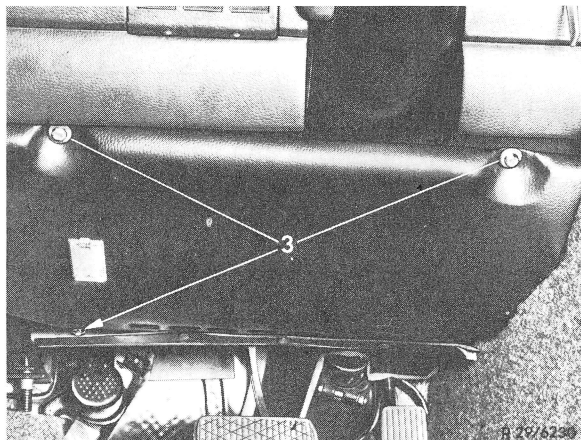

Fig. 4
3 Fastening bolts

6 Unscrew hex. screw (3) and remove bushing (4) from brake pedal (1), so that the push rod of the brake unit on brake pedal is released (Fig. 6 and 7).

7 Unscrew hex. nut for attaching brake unit to front end.

8 Remove brake unit.

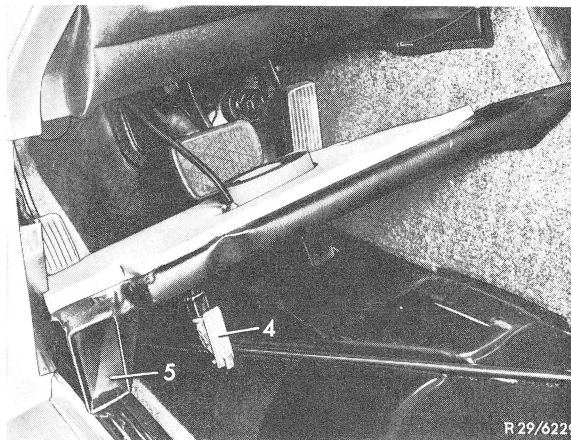

Fig. 5
4 Legroom light 5 Slot for door ventilation

Installation

9 Attach brake unit to front end. Screw-in lefthand upper hex. nut via a hole in front end via direction of engine compartment (refer to Fig. 3). Tighten hex. nuts to 15 Nm (1,5 kpm). Insert rubber cover after tightening this hex. nut.

10 Attach thrust rod (2) of brake unit with bushing (4) and hex. bolt (3) to brake pedal (1) (Fig. 7).

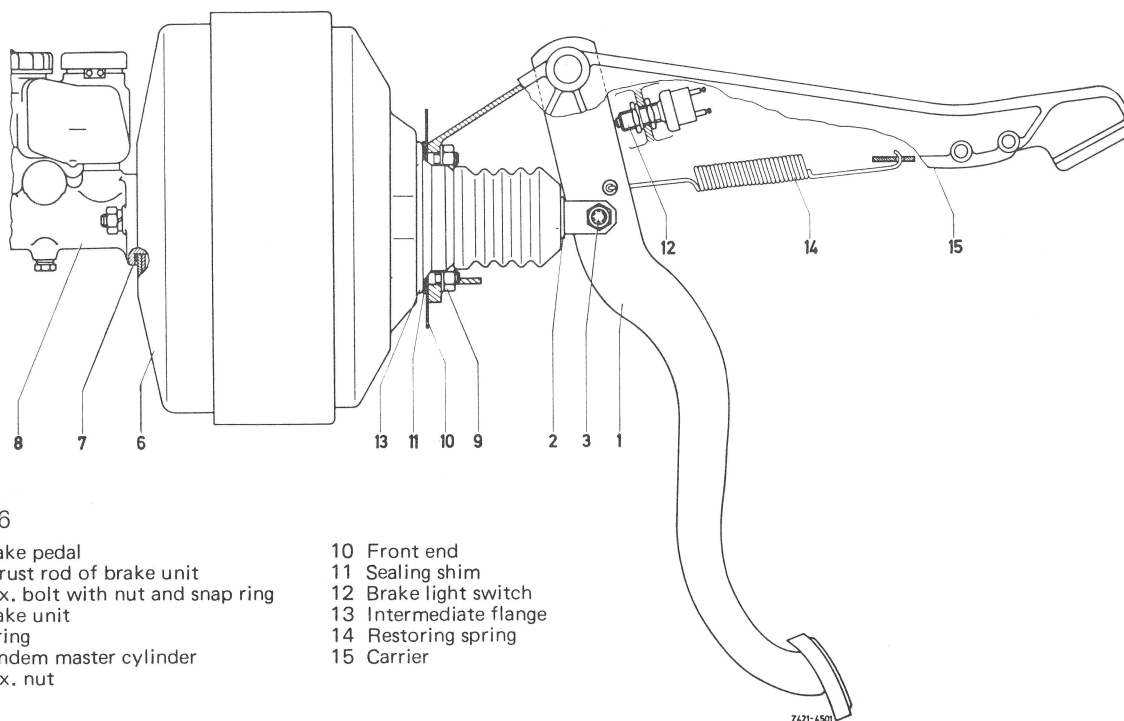

Fig. 6

1 Brake pedal	10 Front end
2 Thrust rod of brake unit	11 Sealing shim
3 Hex. bolt with nut and snap ring	12 Brake light switch
6 Brake unit	13 Intermediate flange
7 O-ring	14 Restoring spring
8 Tandem master cylinder	15 Carrier
9 Hex. nut	

11 Pull cable for legroom light through cover, insert plug and force legroom light (4) into cover (Fig. 5).

12 Introduce legroom cover and screw down (Fig. 4).

13 Connect vacuum line to brake unit, tighten pipe nut to 30 Nm (3 kpm).

14 Install tandem master cylinder (42.1-310).

15 Test check valve (42.0*-023).

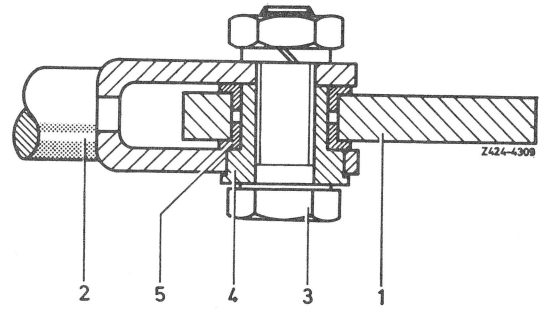

Fig. 7

- | | |
|------------------------------------|-------------------|
| 1 Brake pedal | 4 Bushing |
| 2 Thrust rod | 5 Bearing bushing |
| 3 Hex. bolt with nut and snap ring | |